

Troubleshooting for Centerpiece™ Roman Shades with AeroLite™ Cordless

Terminology:

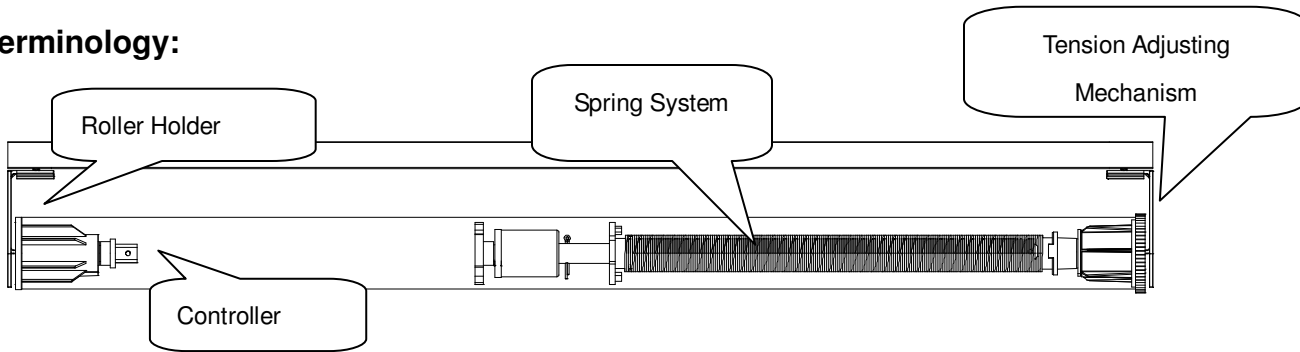

Situation 1: The shade can be fully released to the bottom, but it can not be lifted upward.

- ⇒ Solution: Take out the controller and reinstall it at another angle. If it does not work yet, it is possible that the controller is broken, please replace the controller.

Situation 2: The shade cannot lock at the bottom or in any position.

- ⇒ Solution: It is possible that the controller is broken. Replace the controller.

Situation 3: The shade can be lifted at normal speed after the spring tension is adjusted, but it slows down or no longer raises to the up after a period of time.

- ⇒ Solution: It is likely the springs in the tension adjusting mechanism have slipped. Replace the Tension Adjusting Mechanism.

How to replace the Tension Adjusting Mechanism?

1. First, loosen the spring tension. Then use a flat head screwdriver to loosen the screws at both ends of the tube and remove the brackets outward from the controller. (See Diagram 1)

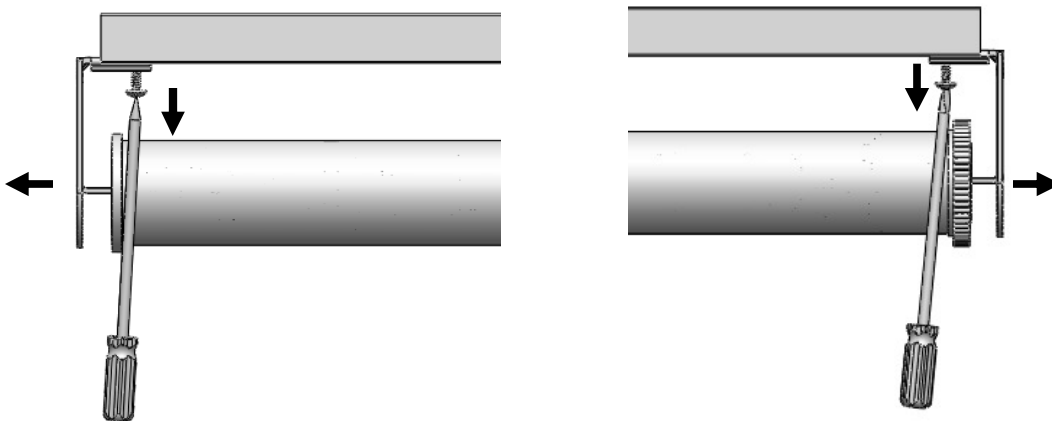

Diagram 1

How to adjust the controller?

Remove the controller and then reinstall it back into the tube at a different angle. (See Diagram 2)

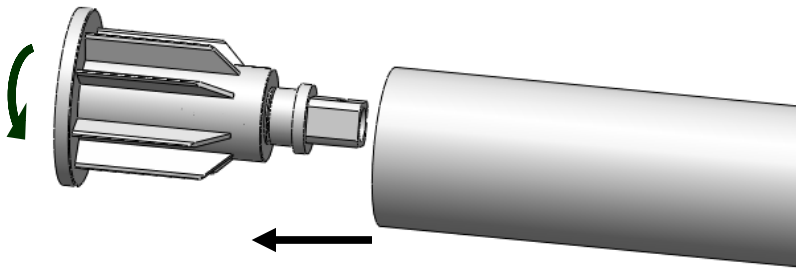

Diagram 2

How to replace the controller?

Remove the original controller and then insert a new controller into the tube. (See Diagram 3)

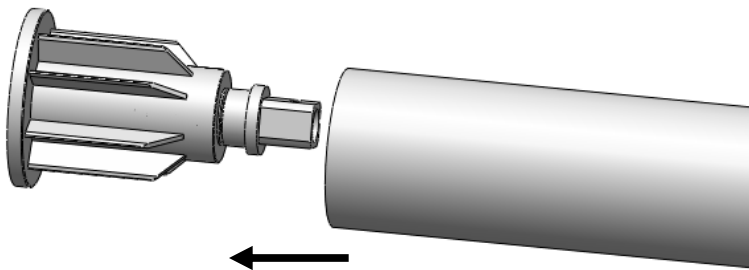

Diagram 3

How to replace the Tension Adjusting Mechanism?

1. First, remove the spring system from the tube. (Diagram 4)

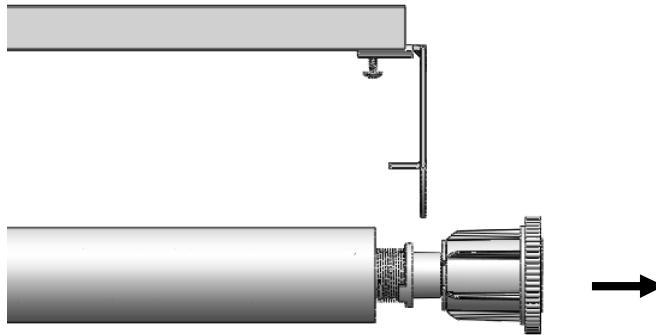

Diagram 4

2. Remove the screws from the tension adjusting mechanism with a cross screwdriver. Replace it with a new tension adjusting mechanism and then insert it into the tube.

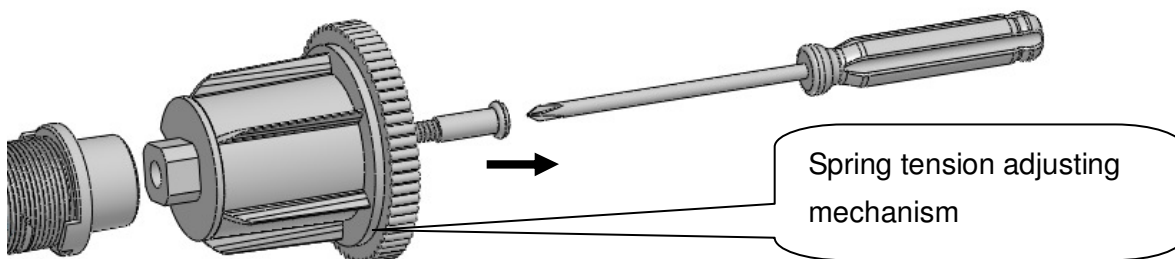

Diagram 5

3. Next, attach the brackets with 2 ± 0.5 mm gaps (refer to Diagram 6); tighten the screws with a flat head screwdriver (refer to Diagram 7). Adjust the wheel to reach the desired speed.

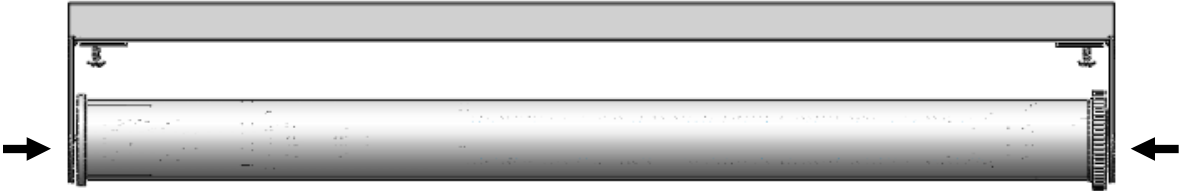

Diagram 6

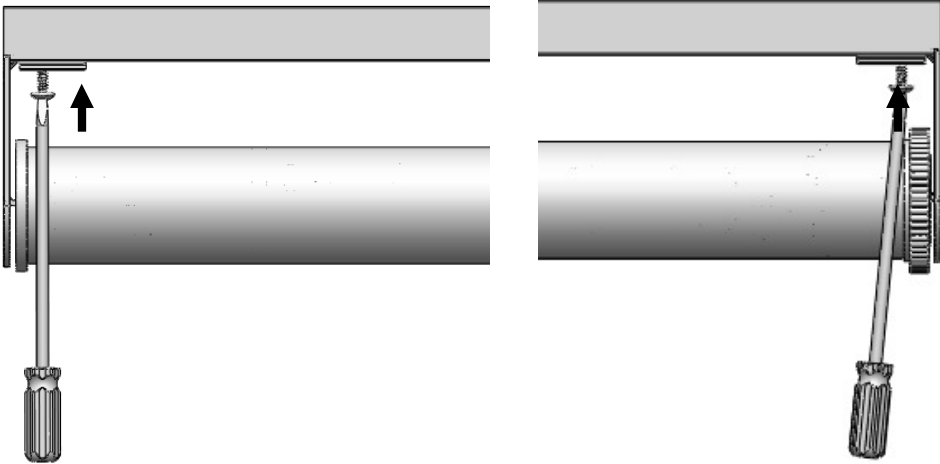

Diagram 7